

A4		REVISIONS		
ZONE	REV	DESCRIPTION	DATE	APPROVED

6mm一级行星减速箱，传动比：5.14:1

6mm 1 stage planetary gearbox with transmission ratio 5.14:1

额定电压 Rated Voltage	3.0V DC
使用环境范围 Operating Condition Temperature Range	-20~+50°C
空载转速 Noload speed	6400±10% rpm
空载电流 Noload Current	≤50 mA
负载转矩 Rated Torque	1.7 g. cm
负载转速 Rated Speed	4600±10% rpm
负载电流 Rated Current	100 mA
堵转电流 Stall Current	230 mA
堵转力矩 Stall Torque	6.5 g. cm
旋向 Direction	CW/CCW
噪音 Noise	≤45 dB
轴向间隙 Axial gap	0.2MAX

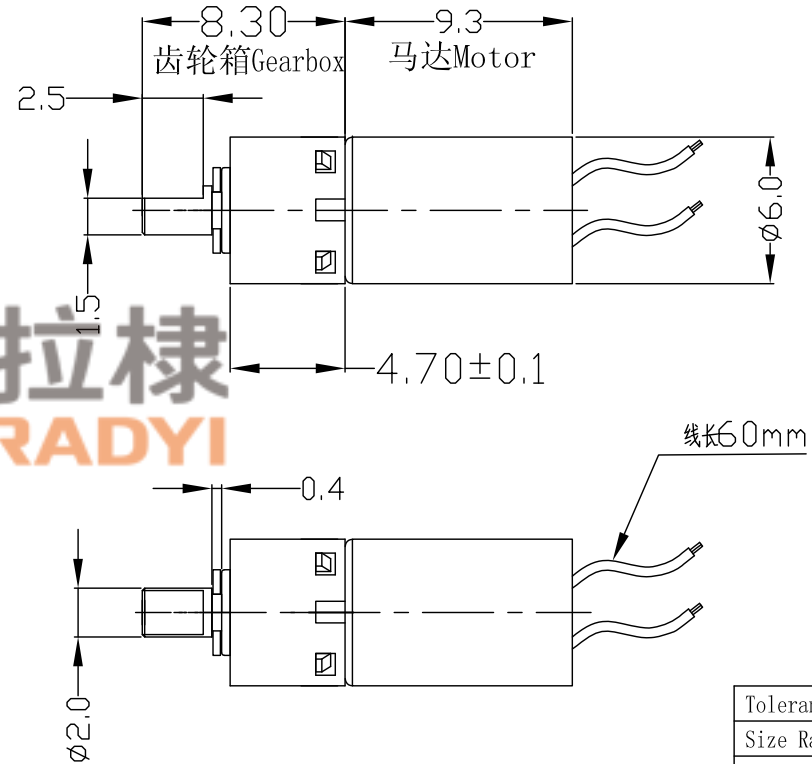
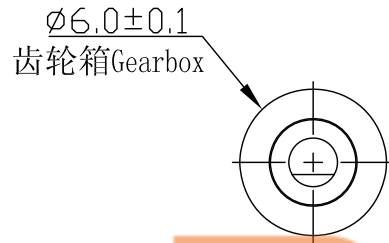

Tolerance (GB/T1804)	
Size Range	Tolerance
Under3	±0.05
3~6	±0.05
6~20	±0.1
Above20	±0.15

噪声测试方法：探头距减速器10cm，环境噪音31db测试
Noise test method: 10cm away from the reducer,
environmental noise 31db

制图 Formulate	黄朝文	2021-7-26	外形图 Outside Drawing		客户确认 Confirmation Approved	
审核 Audit			PART NO.: GB06-5.14-MD16001-1-M			
批准 Approved			Scale	1:1	version	A
			⊕	⊖	重量	
						共1页 第1页

A4 REVISIONS				
ZONE	REV	DESCRIPTION	DATE	APPROVED

6mm二级行星减速箱，传动比：26.45:1

6mm 2 stage planetary gearbox with transmission ratio 26.45:1

额定电压 Rated Voltage	3.0V DC
使用环境范围 Operating Condition Temperature Range	-20~+50°C
空载转速 Noload speed	1200±10% rpm
空载电流 Noload Current	≤60 mA
负载转矩 Rated Torque	7.5 g. cm
负载转速 Rated Speed	900±10% rpm
负载电流 Rated Current	100 mA
堵转电流 Stall Current	230 mA
堵转力矩 Stall Torque	28 g. cm
旋向 Direction	CW/CCW
噪音 Noise	≤45 dB
轴向间隙 Axial gap	0.2MAX

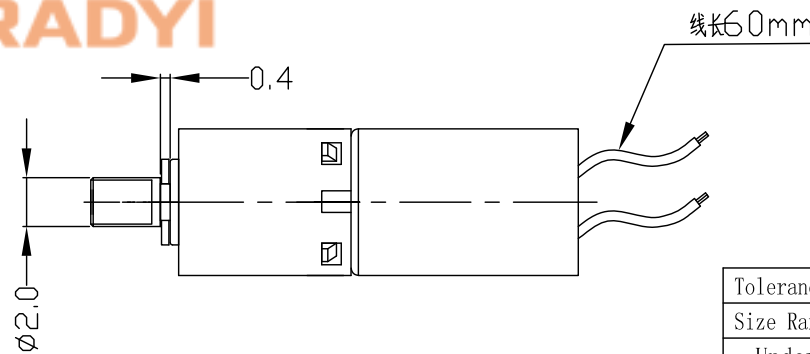
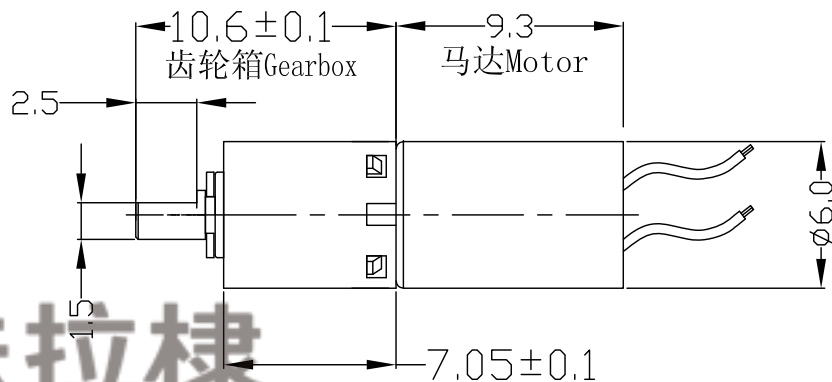
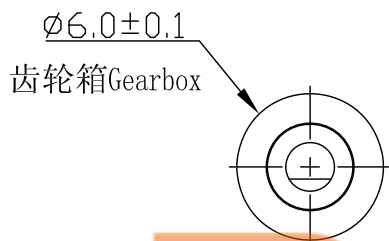

Tolerance (GB/T1804)	
Size Range	Tolerance
Under3	±0.05
3~6	±0.05
6~20	±0.1
Above20	±0.15

噪声测试方法：探头距减速器10cm, 环境噪音31db测试
Noise test method: 10cm away from the reducer,
environmental noise 31db

制图 Formulate	黄朝文	2021-7-26	外形图 Outside Drawing		客户确认 Confirmation Approved	
审核 Audit			PART NO.: GB06-26.45-MD16001-1-M			
批准 Approved			Scale	1:1	version	A
			⊕	⊖	重量	
						共1页 第1页

A4 REVISIONS				
ZONE	REV	DESCRIPTION	DATE	APPROVED

6mm 三级行星减速箱，传动比：136.02:1

6mm 3 stage planetary gearbox with transmission ratio 136.02:1

额定电压 Rated Voltage	3.0V DC
使用环境范围 Operating Condition Temperature Range	-20~+50°C
空载转速 Noload speed	240±15% rpm
空载电流 Noload Current	≤40 mA
负载转矩 Rated Torque	33 g. cm
负载转速 Rated Speed	175±15% rpm
负载电流 Rated Current	100 mA
堵转电流 Stall Current	230 mA
堵转力矩 Stall Torque	125 g. cm
旋向 Direction	CW/CCW
噪音 Noise	≤45 dB
轴向间隙 Axial gap	0.2MAX

∅6.0±0.1
齿轮箱Gearbox

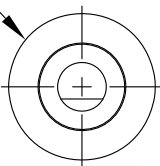

法拉棣
FARADYI

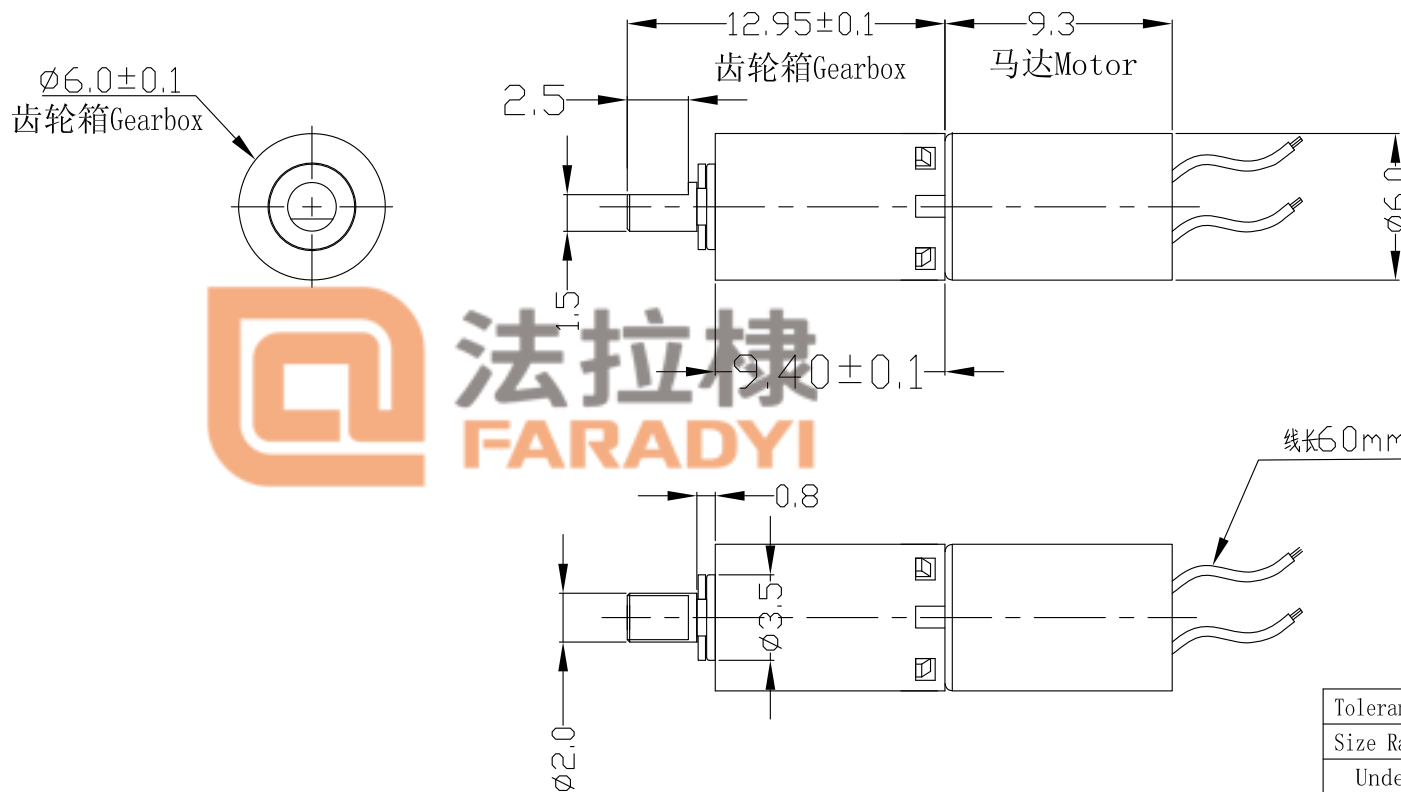

噪声测试方法：探头距减速器10cm, 环境噪音31db测试

Noise test method: 10cm away from the reducer,
environmental noise 31db

Tolerance (GB/T1804)	
Size Range	Tolerance
Under3	±0.05
3~6	±0.05
6~20	±0.1
Above20	±0.15

制图 Formulate	黄朝文	2021-7-26	外形图 Outside Drawing		客户确认 Confirmation Approved	
审核 Audit			PART NO.:GB06-136-MD16001-1-M			
批准 Approved			Scale	1:1	version	A
			重量			

A4 REVISIONS				
ZONE	REV	DESCRIPTION	DATE	APPROVED

6mm四级行星减速箱，传动比：699.55: 1

6mm 4 stage planetary gearbox with transmission ratio 699.55:1

额定电压 Rated Voltage	3.0V DC
使用环境范围 Operating Condition Temperature Range	-20~+50°C
空载转速 Noload speed	45±15% rpm
空载电流 Noload Current	≤50 mA
负载转矩 Rated Torque	130 g. cm
负载转速 Rated Speed	34±15% rpm
负载电流 Rated Current	80 mA
堵转电流 Stall Current	200 mA
堵转力矩 Stall Torque	480 g. cm
旋向 Direction	CW/CCW
噪音 Noise	≤45 dB
轴向间隙 Axial gap	0.2MAX

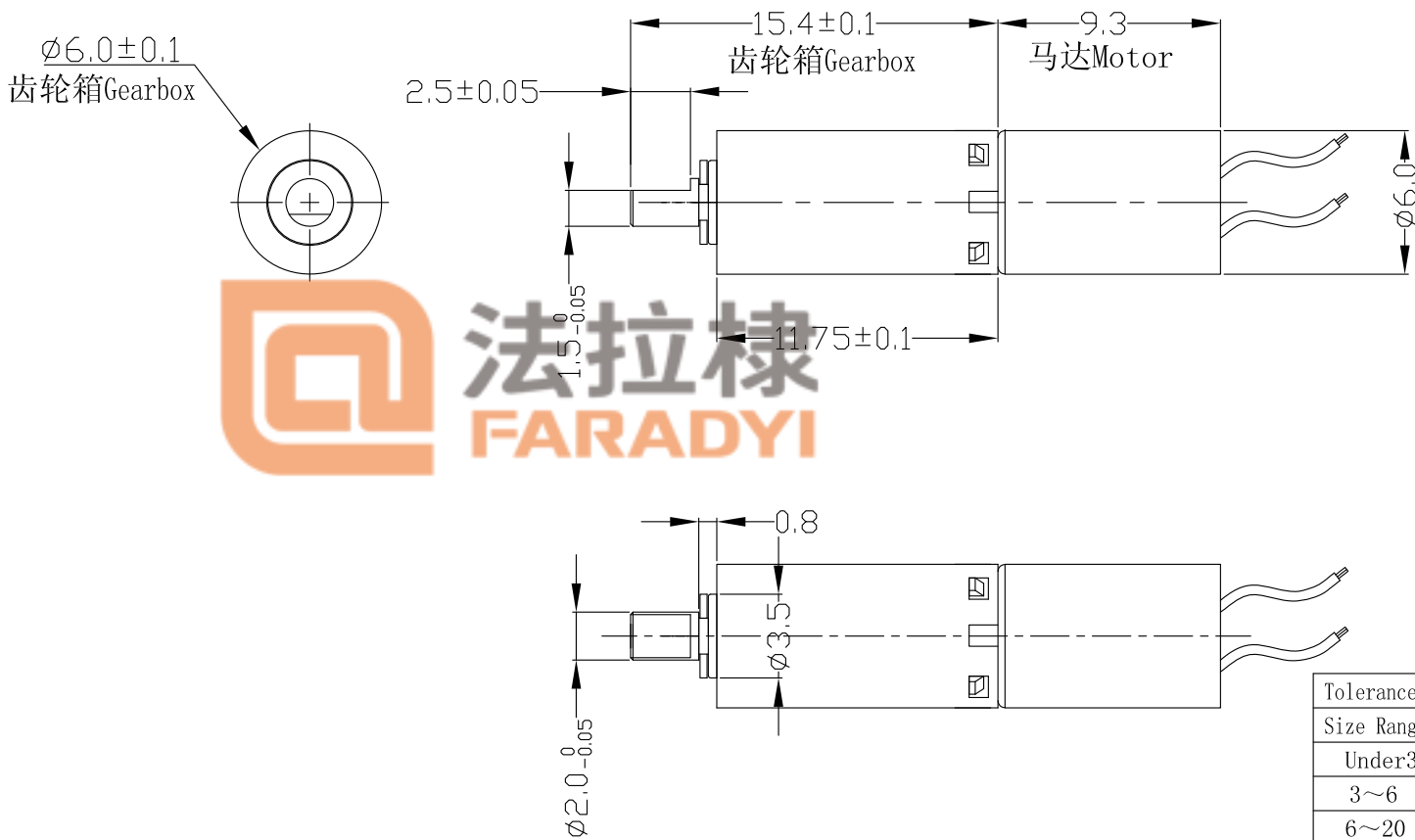

噪声测试方法：探头距减速器10cm，环境噪音31db测试
Noise test method: 10cm away from the reducer,
environmental noise 31db

Tolerance (GB/T1804)	
Size Range	Tolerance
Under3	±0.05
3~6	±0.05
6~20	±0.1
Above20	±0.15

制图 Formulate	黄朝文	2021-7-26	外形图 Outside Drawing		客户确认 Confirmation Approved	
审核 Audit			PART NO.:GB06-700-MD16001-1-M			
批准 Approved			Scale	1:1	version	A
			⊕	⊖	重量	
						共1页 第1页

A4 REVISIONS				
ZONE	REV	DESCRIPTION	DATE	APPROVED

10mm行星减速箱, 传动比: 171

10mm planetary gearbox with transmission ratio 171:1

额定电压 Rated Voltage	3.0V DC
使用环境范围 Operating Condition Tempertature Range	-20~+50°C
空载转速 Noload speed	63±10% rpm
空载电流 Noload Current	≤60 mA
负载转矩 Rated Torque	110 g. cm
负载转速 Rated Speed	43±10% rpm
负载电流 Rated Current	100 mA
堵转电流 Stall Current	140 mA
堵转力矩 Stall Torque	400 g. cm
旋向 Direction	CW/CCW
噪音 Noise	≤48 dB
轴向间隙 Axial gap	0.2MAX

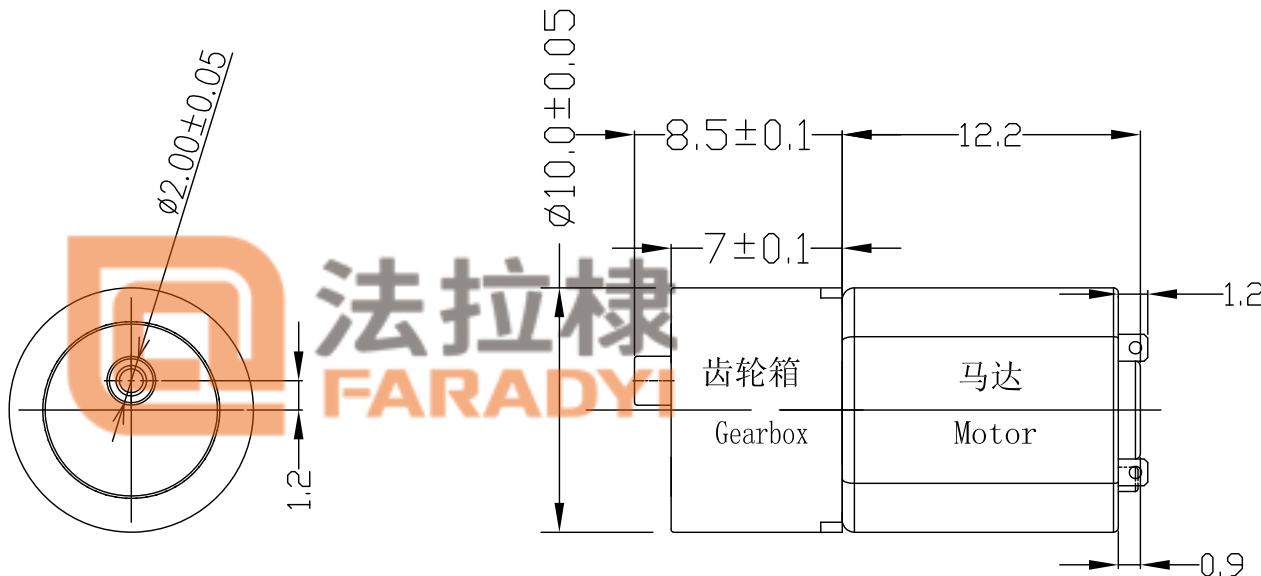

噪声测试方法: 探头距减速器10cm, 环境噪音31db测试
Noise test method: 10cm away from the reducer,
environmental noise 31db

Tolerance (GB/T1804)	
Size Range	Tolerance
Under3	±0.05
3~6	±0.05
6~20	±0.1
Above20	±0.15

制图 Formulate	黄朝文	2021-7-26	外形图 Outside Drawing		客户确认 Confirmation Approved	
审核 Audit			PART NO.: GB10-171-MD17001-1-M			
批准 Approved			Scale	1:1	version	A
			⊕	⊖	重量	
						共1页 第1页

A4 REVISIONS				
ZONE	REV	DESCRIPTION	DATE	APPROVED

10mm行星减速箱，传动比：171

10mm planetary gearbox with transmission ratio 171:1

额定电压 Rated Voltage	3.0V DC
使用环境范围 Operating Condition Tempertature Range	-20~+50°C
空载转速 Noload speed	63±10% rpm
空载电流 Noload Current	≤60 mA
负载转矩 Rated Torque	110 g. cm
负载转速 Rated Speed	43±10% rpm
负载电流 Rated Current	100 mA
堵转电流 Stall Current	140 mA
堵转力矩 Stall Torque	400 g. cm
旋向 Direction	CW/CCW
噪音 Noise	≤48 dB
轴向间隙 Axial gap	0.2MAX

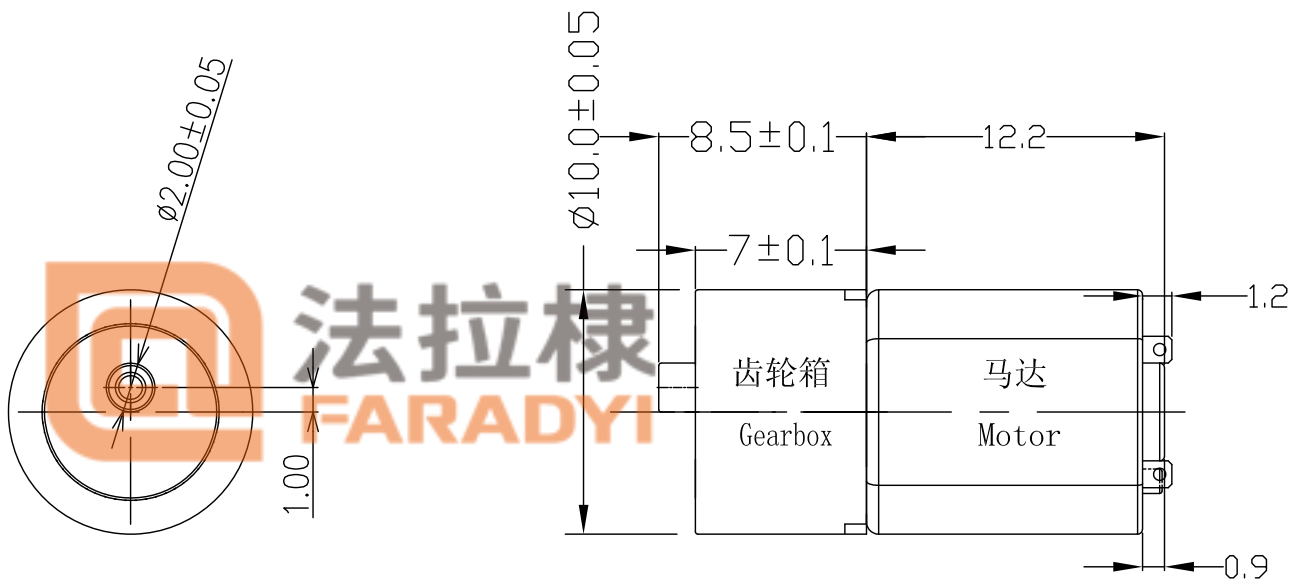

噪声测试方法：探头距减速器10cm，环境噪音31db测试
Noise test method: 10cm away from the reducer,
environmental noise 31db

Tolerance (GB/T1804)	
Size Range	Tolerance
Under3	±0.05
3~6	±0.05
6~20	±0.1
Above20	±0.15

制图 Formulate	黄朝文	2021-7-26	外形图 Outside Drawing		客户确认 Confirmation Approved	
审核 Audit			PART NO.: GB10-171-MD17001-2-M			
批准 Approved			Scale	1:1	version	A
			⊕	⊖	重量	
						共1页 第1页

A4 REVISIONS				
ZONE	REV	DESCRIPTION	DATE	APPROVED

10mm行星减速箱，传动比：171

10mm planetary gearbox with transmission ratio 171:1

额定电压 Rated Voltage	3.0V DC
使用环境范围 Operating Condition Tempertature Range	-20~+50°C
空载转速 Noload speed	63±10% rpm
空载电流 Noload Current	≤60 mA
负载转矩 Rated Torque	110 g. cm
负载转速 Rated Speed	43±10% rpm
负载电流 Rated Current	100 mA
堵转电流 Stall Current	140 mA
堵转力矩 Stall Torque	400 g. cm
旋向 Direction	CW/CCW
噪音 Noise	≤48 dB
轴向间隙 Axial gap	0.2MAX

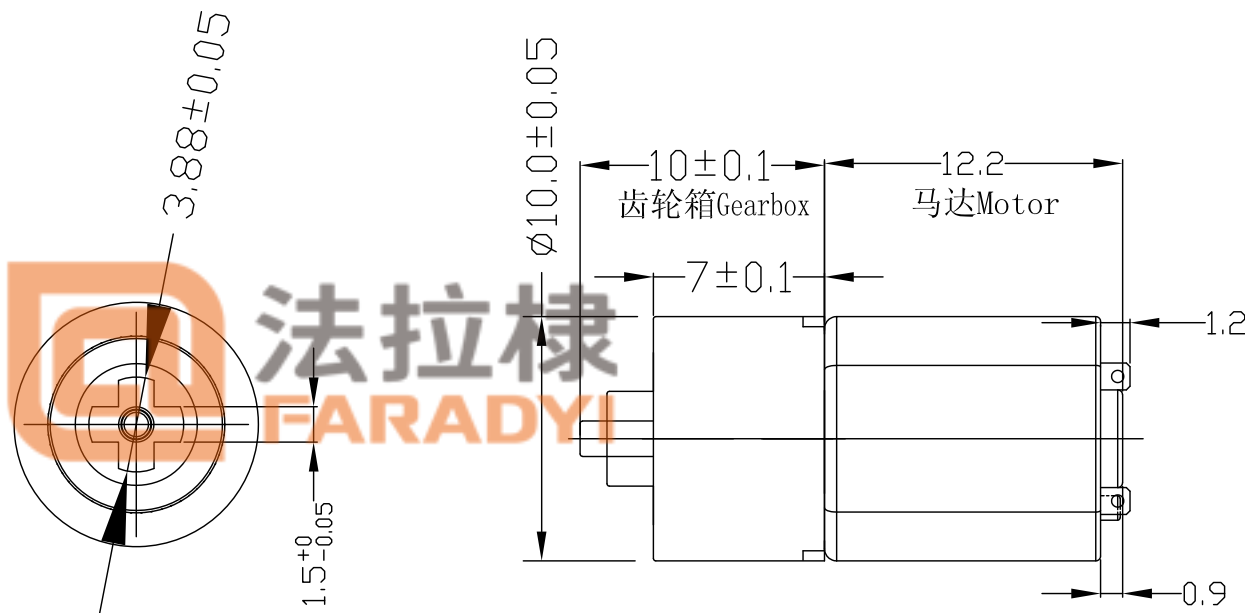

噪声测试方法：探头距减速器10cm, 环境噪音31db测试
Noise test method: 10cm away from the reducer,
environmental noise 31db

Tolerance (GB/T1804)	
Size Range	Tolerance
Under3	±0.05
3~6	±0.05
6~20	±0.1
Above20	±0.15

制图 Formulate	黄朝文	2021-7-26	外形图 Outside Drawing		客户确认 Confirmation Approved	
审核 Audit			PART NO.: GB10-171-MD17001-3-M3.0			
批准 Approved			Scale	1:1	version	A
			⊕	⊖	重量	
						共1页 第1页

A4 REVISIONS				
ZONE	REV	DESCRIPTION	DATE	APPROVED

10mm行星减速箱，传动比：171

10mm planetary gearbox with transmission ratio 171:1

额定电压 Rated Voltage	3.0V DC
使用环境范围 Operating Condition Tempertature Range	-20~+50°C
空载转速 Noload speed	63±10% rpm
空载电流 Noload Current	≤60 mA
负载转矩 Rated Torque	110 g. cm
负载转速 Rated Speed	43±10% rpm
负载电流 Rated Current	100 mA
堵转电流 Stall Current	140 mA
堵转力矩 Stall Torque	400 g. cm
旋向 Direction	CW/CCW
噪音 Noise	≤48 dB
轴向间隙 Axial gap	0.2MAX

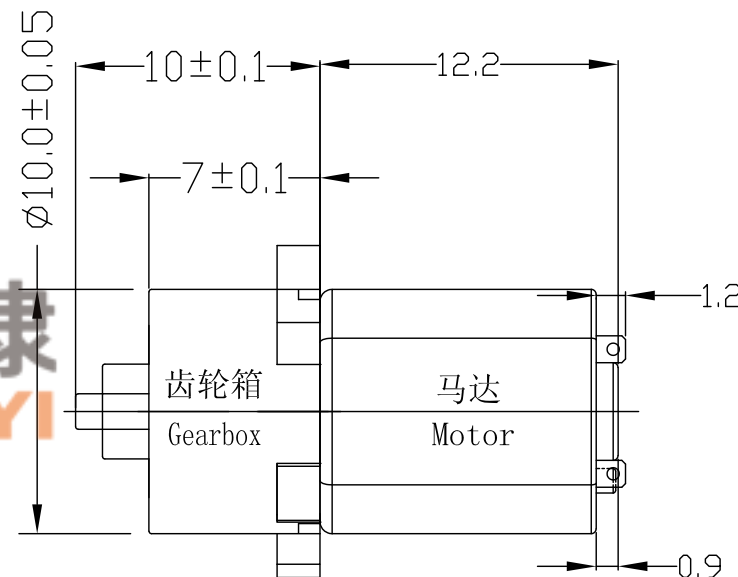
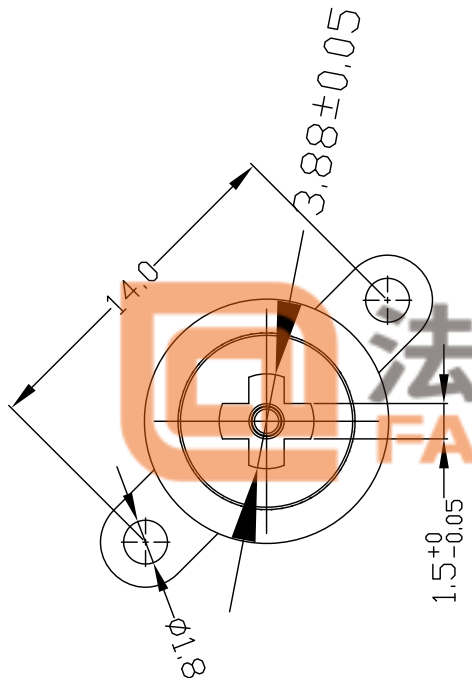

噪声测试方法：探头距减速器10cm, 环境噪音31db测试
Noise test method: 10cm away from the reducer,
environmental noise 31db

Tolerance (GB/T1804)	
Size Range	Tolerance
Under3	±0.05
3~6	±0.05
6~20	±0.1
Above20	±0.15

制图 Formulate	黄朝文	2021-7-26	外形图 Outside Drawing		客户确认 Confirmation Approved	
审核 Audit			PART NO.: GB10-171-MD17001-4-M3.0			
批准 Approved			Scale	1:1	version	A
			⊕	≡	重量	
						共1页 第1页

A4 REVISIONS				
ZONE	REV	DESCRIPTION	DATE	APPROVED

10mm行星减速箱，传动比：171

10mm planetary gearbox with transmission ratio 171:1

额定电压 Rated Voltage	3.0V DC
使用环境范围 Operating Condition Tempertature Range	-20~+50°C
空载转速 Noload speed	63±10% rpm
空载电流 Noload Current	≤60 mA
负载转矩 Rated Torque	110 g. cm
负载转速 Rated Speed	43±10% rpm
负载电流 Rated Current	100 mA
堵转电流 Stall Current	140 mA
堵转力矩 Stall Torque	400 g. cm
旋向 Direction	CW/CCW
噪音 Noise	≤48 dB
轴向间隙 Axial gap	0.2MAX

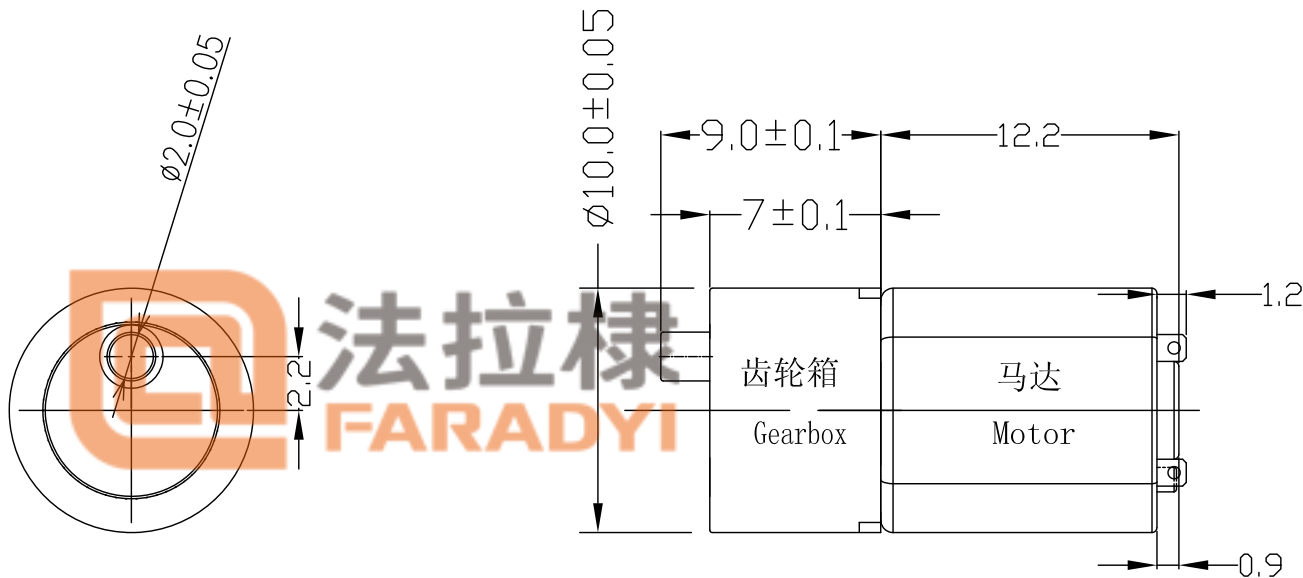

噪声测试方法：探头距减速器10cm, 环境噪音31db测试
Noise test method: 10cm away from the reducer,
environmental noise 31db

Tolerance (GB/T1804)	
Size Range	Tolerance
Under3	±0.05
3~6	±0.05
6~20	±0.1
Above20	±0.15

制图 Formulate	黄朝文	2021-7-26	外形图 Outside Drawing		客户确认 Confirmation Approved	
审核 Audit			PART NO.: GB10-171-MD17001-5-M			
批准 Approved			Scale	1:1	version	A
			⊕	⊖	重量	
						共1页 第1页

A4 REVISIONS				
ZONE	REV	DESCRIPTION	DATE	APPROVED

12mm行星减速箱，传动比：120:1

12mm planetary gearbox with transmission ratio 120:1

额定电压 Rated Voltage	3.0V DC
使用环境范围 Operating Condition Tempertature Range	-20~+50°C
空载转速 Noload speed	110±10% rpm
空载电流 Noload Current	≤80 mA
负载转矩 Rated Torque	110 g. cm
负载转速 Rated Speed	92±10% rpm
负载电流 Rated Current	150 mA
堵转电流 Stall Current	650 mA
堵转力矩 Stall Torque	430 g. cm
旋向 Direction	CW/CCW
噪音 Noise	≤50 dB
轴向间隙 Axial gap	0.2MAX



法拉棧
FARADYI

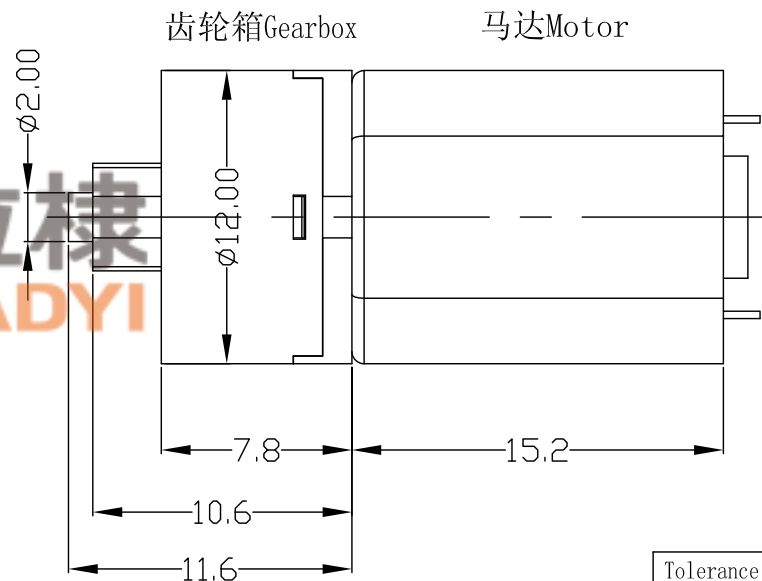

Tolerance (GB/T1804)	
Size Range	Tolerance
Under3	±0.05
3~6	±0.05
6~20	±0.1
Above20	±0.15

噪声测试方法：探头距减速器10cm，环境噪音31db测试
Noise test method: 10cm away from the reducer,
environmental noise 31db

制图 Formulate	黄朝文	2021-7-26	外形图 Outside Drawing		客户确认 Confirmation Approved	
审核 Audit			PART NO.:GB12-120-MD18001-1-M3.0			
批准 Approved			Scale	1:1	version	A
			⊕	⊖	重量	
						共1页 第1页

A4 REVISIONS				
ZONE	REV	DESCRIPTION	DATE	APPROVED

12mm行星减速箱，传动比：120:1

12mm planetary gearbox with transmission ratio 120:1

额定电压 Rated Voltage	5.0V DC
使用环境范围 Operating Condition Tempertature Range	-20~+50°C
空载转速 Noload speed	105±10% rpm
空载电流 Noload Current	≤80 mA
负载转矩 Rated Torque	110 g. cm
负载转速 Rated Speed	90±10% rpm
负载电流 Rated Current	150 mA
堵转电流 Stall Current	650 mA
堵转力矩 Stall Torque	430 g. cm
旋向 Direction	CW/CCW
噪音 Noise	≤50 dB
轴向间隙 Axial gap	0.2MAX

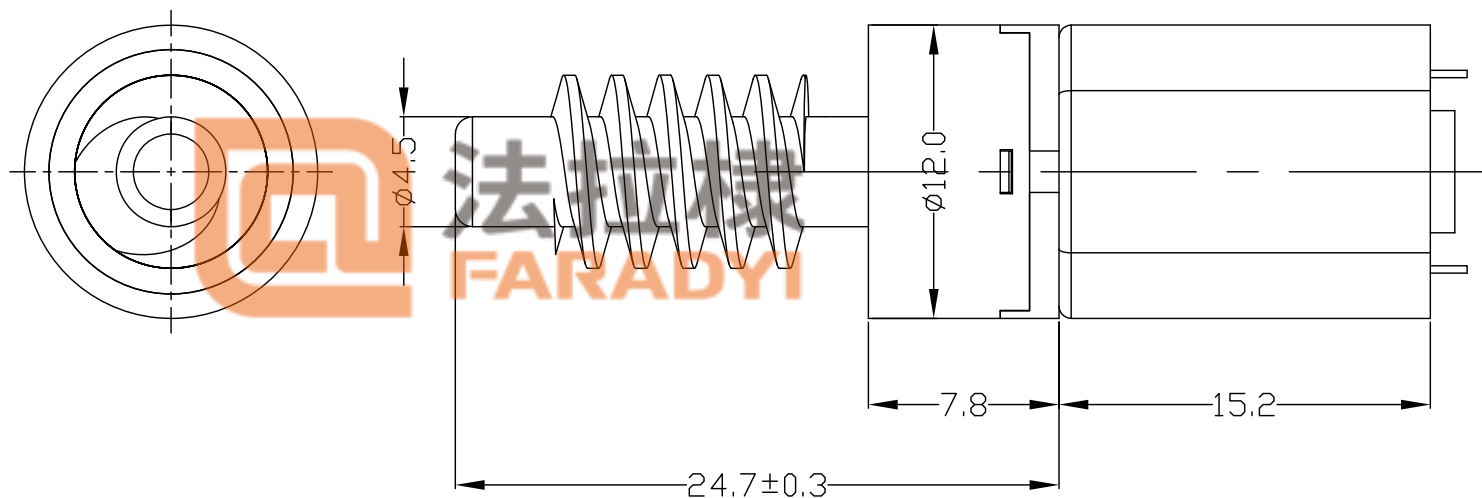

噪声测试方法：探头距减速器10cm, 环境噪音31db测试
Noise test method: 10cm away from the reducer,
environmental noise 31db

Tolerance (GB/T1804)	
Size Range	Tolerance
Under3	±0.05
3~6	±0.05
6~20	±0.1
Above20	±0.15

制图 Formulate	黄朝文	2021-7-26	外形图 Outside Drawing		客户确认 Confirmation Approved	
审核 Audit			PART NO.: GB12-120-MD18001-2-M			
批准 Approved			Scale	1:1	version	A
			⊕	⊖	重量	
						共1页 第1页

A4		REVISIONS			
ZONE	REV	DESCRIPTION	DATE	APPROVED	

12mm行星减速箱多种减速比

12mm planetary reduction gearbox, Multiple reduction ratio

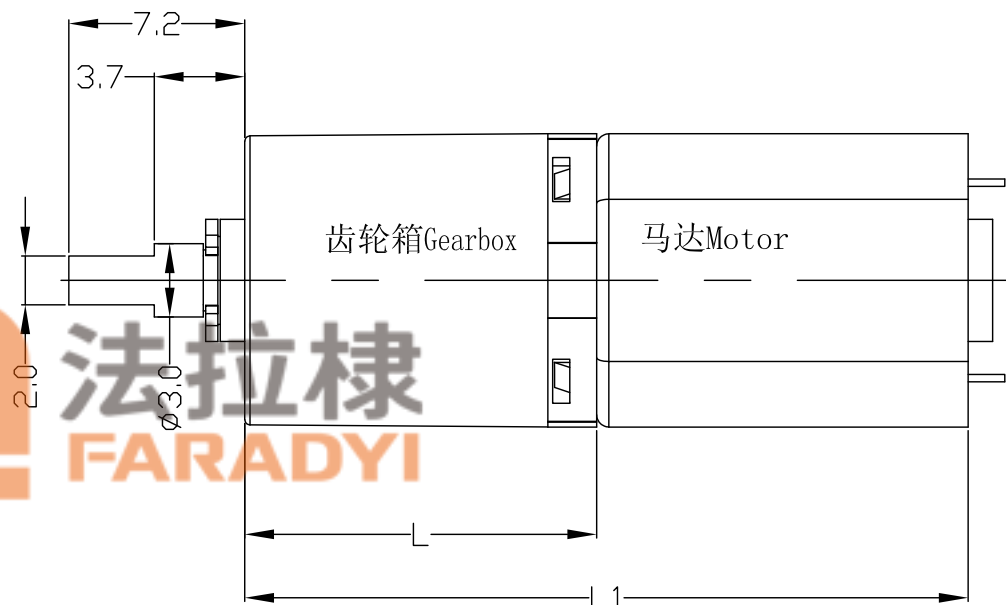
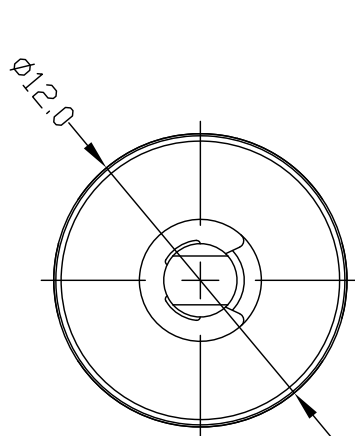

产品规格 Specifications	额定值 Rated	空载 No load		额定负载 Rated load			减速箱 长度L Gearbox length L	总长L1 Altogether length L1
	电压 Voltage	转速 speed	电流 Current	转速 speed	电流 Current	扭矩 Torque		
	VDC	rpm	mA	rpm	mA	g. cm		
GB12-4-MD18003-1-M	3.0	3375	50	2800	150	8.0	6.8	22.0
GB12-6-MD18003-1-M	3.0	2250	50	1866	150	12.0		
GB12-16-MD18003-1-M	3.0	843	50	700	150	30.3	10.6	25.8
GB12-24-MD18003-1-M	3.0	562	50	466	150	45.5		
GB12-36-MD18003-1-M	3.0	375	50	311	150	68.2	14.4	29.6
GB12-64-MD18003-1-M	3.0	210	55	175	160	115.2		
GB12-96-MD18003-1-M	3.0	140	55	116	160	172.8	18.2	33.4
GB12-144-MD18003-1-M	3.0	93	55	77	160	259.2		
GB12-216-MD18003-1-M	3.0	62.5	55	51.8	160	388.9	18.2	33.4
GB12-256-MD18003-1-M	3.0	52.7	60	43.7	170	437.8		
GB12-384-MD18003-1-M	3.0	35.1	60	29.1	170	656.8	18.2	33.4
GB12-576-MD18003-1-M	3.0	23.4	60	19.4	170	985.2		
GB12-864-MD18003-1-M	3.0	15.6	60	12.9	170	1477.8	18.2	33.4
GB12-1296-MD18003-1-M	3.0	10.4	60	8.6	170	2216.7		

Noise ≤ 47db

噪声测试方法: 探头距减速器20cm, 环境噪音31db测试

Noise test method: 10cm away from the reducer,
environmental noise 31db

Tolerance (GB/T1804)	
Size Range	Tolerance
Under3	±0.05
3~6	±0.05
6~20	±0.1
Above20	±0.15

制图 Formulate	黄朝文	2021-7-26	外形图 Outside Drawing			客户确认 Confirmation Approved	
审核 Audit			PART NO.:				
批准 Approved			Scale	1:1	version		
			⊕	⊖	重量		
							共1页
							第1页

A4 REVISIONS				
ZONE	REV	DESCRIPTION	DATE	APPROVED

14x26mm方形减速箱 250: 1

14x26mm Square reducer with gear ratio 250: 1

额定电压 Rated Voltage	3.0V DC
使用环境范围 Operating Condition Tempertature Range	-20~+50°C
空载转速 Noload speed	54 ±10% rpm
空载电流 Noload Current	≤80 mA
负载转矩 Rated Torque	380 g. cm
负载转速 Rated Speed	44±10% rpm
负载电流 Rated Current	150 mA
堵转电流 Stall Current	650 mA
堵转力矩 Stall Torque	1300 g. cm
旋向 Direction	CW/CCW
噪音 Noise	≤55 dB
轴向间隙 Axial gap	0.2MAX

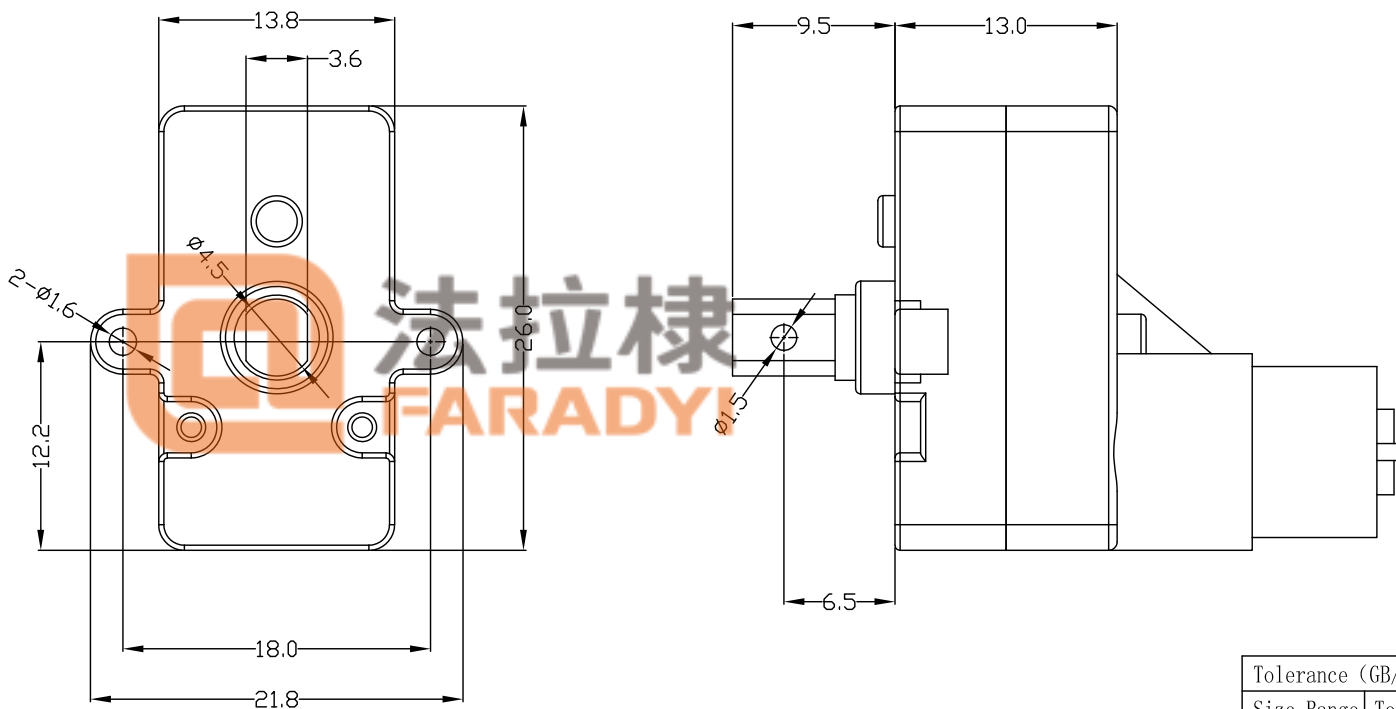

噪声测试方法: 探头距减速器20cm, 环境噪音31db测试
Noise test method: 20cm away from the reducer,
environmental noise 31db

Tolerance (GB/T1804)	
Size Range	Tolerance
Under3	±0.05
3~6	±0.05
6~20	±0.1
Above20	±0.15

制图 Formulate	黄朝文	2021-7-26	外形图 Outside Drawing		客户确认 Confirmation Approved	
审核 Audit			PART NO.: GB14x26-250-MD18004-1-M			
批准 Approved			Scale	1:1	version	A
			⊕	⊖	重量	
						共1页 第1页

REVISIONS				
ZONE	REV	DESCRIPTION	DATE	APPROVED

16mm行星减速箱多种减速比

16mm planetary reduction gearbox, Multiple reduction ratio

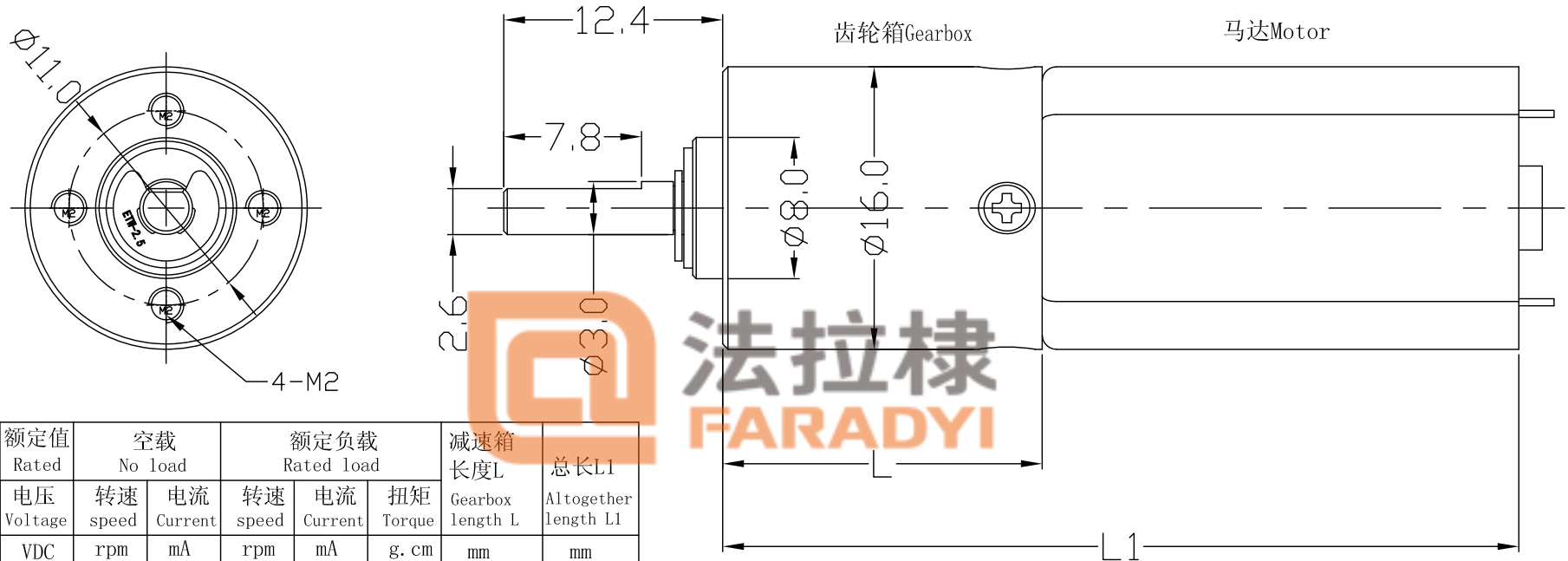

产品规格 Specifications	额定值 Rated	空载 No load			额定负载 Rated load			减速箱 长度L Gearbox length L	总长L1 Altogether length L1
	电压 Voltage	转速 speed	电流 Current	转速 speed	电流 Current	扭矩 Torque	mm	mm	
	VDC	rpm	mA	rpm	mA	g. cm			
GB16-16-MD18005-1-M	5.0	375	50	281	180	130	14.8	41.8	
GB16-24-MD18005-1-M	5.0	250	50	187.5	180	195			
GB16-36-MD18005-1-M	5.0	166.5	50	125	180	291			
GB16-64-MD18005-1-M	5.0	93.5	55	70	190	467.2	18.1	45.1	
GB16-96-MD18005-1-M	5.0	62.5	55	46.5	190	700.8			
GB16-144-MD18005-1-M	5.0	41.5	55	31	190	1051.2			
GB16-216-MD18005-1-M	5.0	27.5	55	20.5	190	1576.8	21.4	48.4	
GB16-256-MD18005-1-M	5.0	23.5	60	17.5	200	1689			
GB16-384-MD18005-1-M	5.0	15.5	60	11.5	200	2534			
GB16-576-MD18005-1-M	5.0	10.5	60	7.8	200	3802			
GB16-864-MD18005-1-M	5.0	7.0	60	5.2	200	5702			
GB16-1296-MD18005-1-M	5.0	4.5	60	3.5	200	8554			
Noise ≤ 47db									



噪声测试方法: 探头距减速器20cm, 环境噪音31db测试
Noise test method: 20cm away from the reducer,
environmental noise 31db

Tolerance (GB/T1804)	
Size Range	Tolerance
Under3	±0.05
3~6	±0.05
6~20	±0.1
Above20	±0.15

制图 Formulate	黄朝文	2021-7-26	外形图 Outside Drawing			客户确认 Confirmation Approved		
审核 Audit			PART NO.:					
批准 Approved			Scale	1:1	version			A
			重量					
							共1页 第1页	

A4 REVISIONS				
ZONE	REV	DESCRIPTION	DATE	APPROVED

20mm行星减速箱多种减速比

20mm planetary reduction gearbox, Multiple reduction ratio

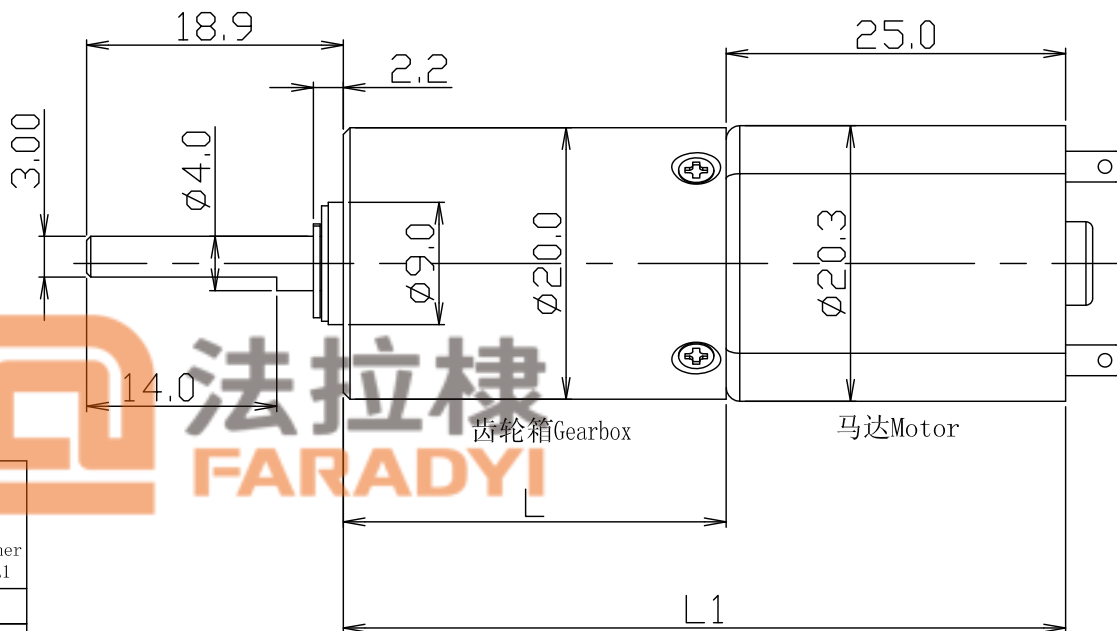
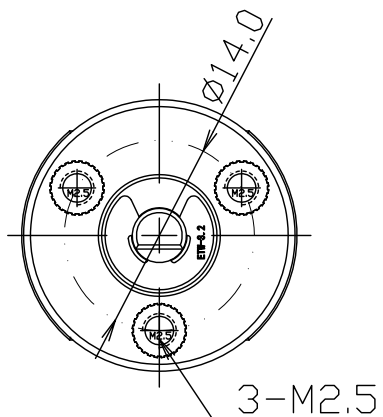

产品规格 Specifications	额定值 Rated	空载 No load		额定负载 Rated load			减速箱 长度L Gearbox length L	总长L1 Altogether length L1
	电压	转速	电流	转速	电流	扭矩		
	VDC	rpm	mA	rpm	mA	g. cm	mm	mm
GB20-4-MD19002-1-M	12.0	1850	35	1575	110	36	17.6	42.6
GB20-6-MD19002-1-M	12.0	1233	35	1050	110	54		
GB20-16-MD19002-1-M	12.0	462.5	40	393	115	130	22.9	47.9
GB20-24-MD19002-1-M	12.0	308	40	262	115	195		
GB20-36-MD19002-1-M	12.0	205	40	175	115	292		
GB20-64-MD19002-1-M	12.0	115.5	45	98	120	466	28.2	53.2
GB20-96-MD19002-1-M	12.0	77	45	65.5	120	700		
GB20-144-MD19002-1-M	12.0	51.3	45	43.5	120	1050	33.5	58.5
GB20-216-MD19002-1-M	12.0	34	45	29	120	1575		
GB20-256-MD19002-1-M	12.0	29	55	24.5	130	1680		
GB20-384-MD19002-1-M	12.0	19	55	16	130	2520	33.5	58.5
GB20-576-MD19002-1-M	12.0	12.8	55	11	130	3780		
GB20-864-MD19002-1-M	12.0	8.5	55	7.3	130	5668		
GB20-1296-MD19002-1-M	12.0	5.7	55	4.8	130	8503		

Noise ≤ 55db

噪声测试方法: 探头距减速器20cm, 环境噪音31db测试

Noise test method: 20cm away from the reducer,
environmental noise 31db

Tolerance (GB/T1804)	
Size Range	Tolerance
Under3	±0.05
3~6	±0.05
6~20	±0.1
Above20	±0.15

制图 Formulate	黄朝文	2021-7-26	外形图 Outside Drawing			客户确认 Confirmation Approved	
审核 Audit			PART NO.:				
批准 Approved			Scale	1:1	version	A	共1页 第1页
			重量				

REVISIONS				
ZONE	REV	DESCRIPTION	DATE	APPROVED

22mm行星减速箱多种减速比

22mm planetary reduction gearbox, Multiple reduction ratio

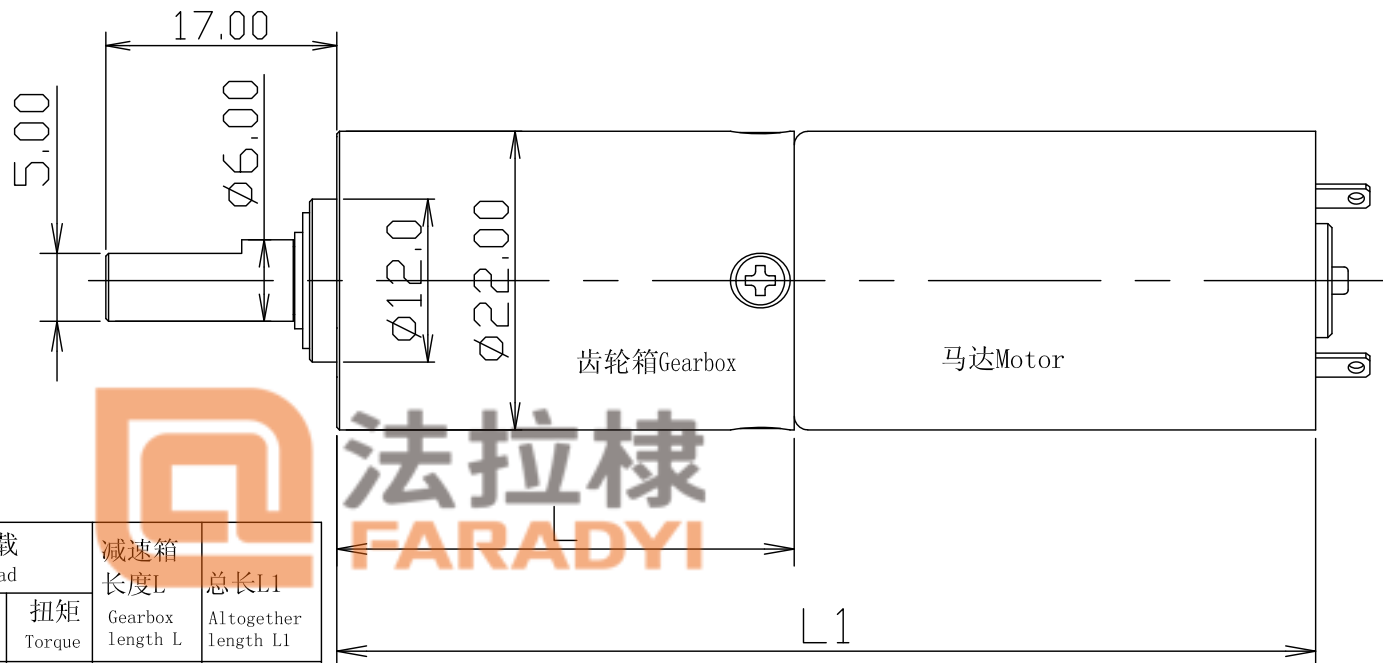
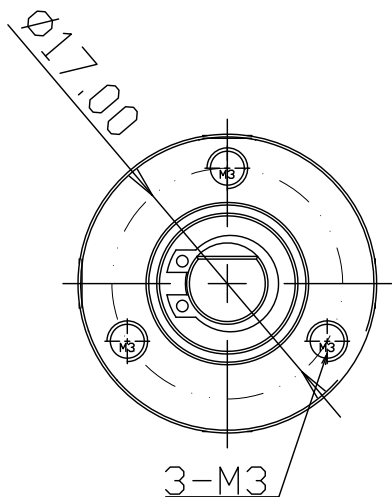

产品规格 Specifications	额定值 Rated		空载 No load		额定负载 Rated load			减速箱 长度L	总长L1
	电压 Voltage	转速 speed	电流 Current	转速 rpm	电压 Voltage	电流 mA	扭矩 Torque	Gearbox length L	Altogether length L1
	VDC	rpm	mA	rpm	mA	g. cm	mm	mm	
GB22-16-MD18002-1-M	12.0	518	100	418	350	720	26.4	64.8	
GB22-24-MD18002-1-M	12.0	345	100	279	350	1080			
GB22-36-MD18002-1-M	12.0	230	100	186	350	1625			
GB22-64-MD18002-1-M	12.0	129	110	104	350	2743	33.7	72.1	
GB22-96-MD18002-1-M	12.0	86	110	69	350	4115			
GB22-144-MD18002-1-M	12.0	57	110	46	350	6173			
GB22-216-MD18002-1-M	12.0	38	110	31	350	9260			
GB22-256-MD18002-1-M	12.0	32	120	26	350	10425	41.0	79.4	
GB22-384-MD18002-1-M	12.0	21	120	17	350	15638			
GB22-576-MD18002-1-M	12.0	14.4	120	11.6	350	23457			
GB22-864-MD18002-1-M	12.0	9.6	120	7.7	350	35186			
GB22-1296-MD18002-1-M	12.0	6.4	120	5.1	350	52780			

Noise ≤ 55db

噪声测试方法: 探头距减速器20cm, 环境噪音31db测试
Noise test method: 20cm away from the reducer,
environmental noise 31db

Tolerance (GB/T1804)	
Size Range	Tolerance
Under3	±0.05
3~6	±0.05
6~20	±0.1
Above20	±0.15

制图 Formulate	黄朝文	2021-7-26	外形图 Outside Drawing			客户确认 Confirmation Approved		
审核 Audit			PART NO.:					
批准 Approved			Scale	1:1	version			A
			⊕	≡	重量			

A4 REVISIONS				
ZONE	REV	DESCRIPTION	DATE	APPROVED

24mm行星减速箱减速比 125: 1

24mm planetary gearbox with transmission ratio 125:1

额定电压 Rated Voltage	3.7V DC
使用环境范围 Operating Condition Temperature Range	-20~+50°C
空载转速 Noload speed	30±3 rpm
空载电流 Noload Current	≤130 mA
负载转矩 Rated Torque	2.2 Kg. cm
负载转速 Rated Speed	25±2.5 rpm
负载电流 Rated Current	350 mA
堵转电流 Stall Current	1.8 A
堵转力矩 Stall Torque	15 Kg. cm
旋向 Direction	CW/CCW
噪音 Noise	≤38 dB
轴向间隙 Axial gap	0.3MAX

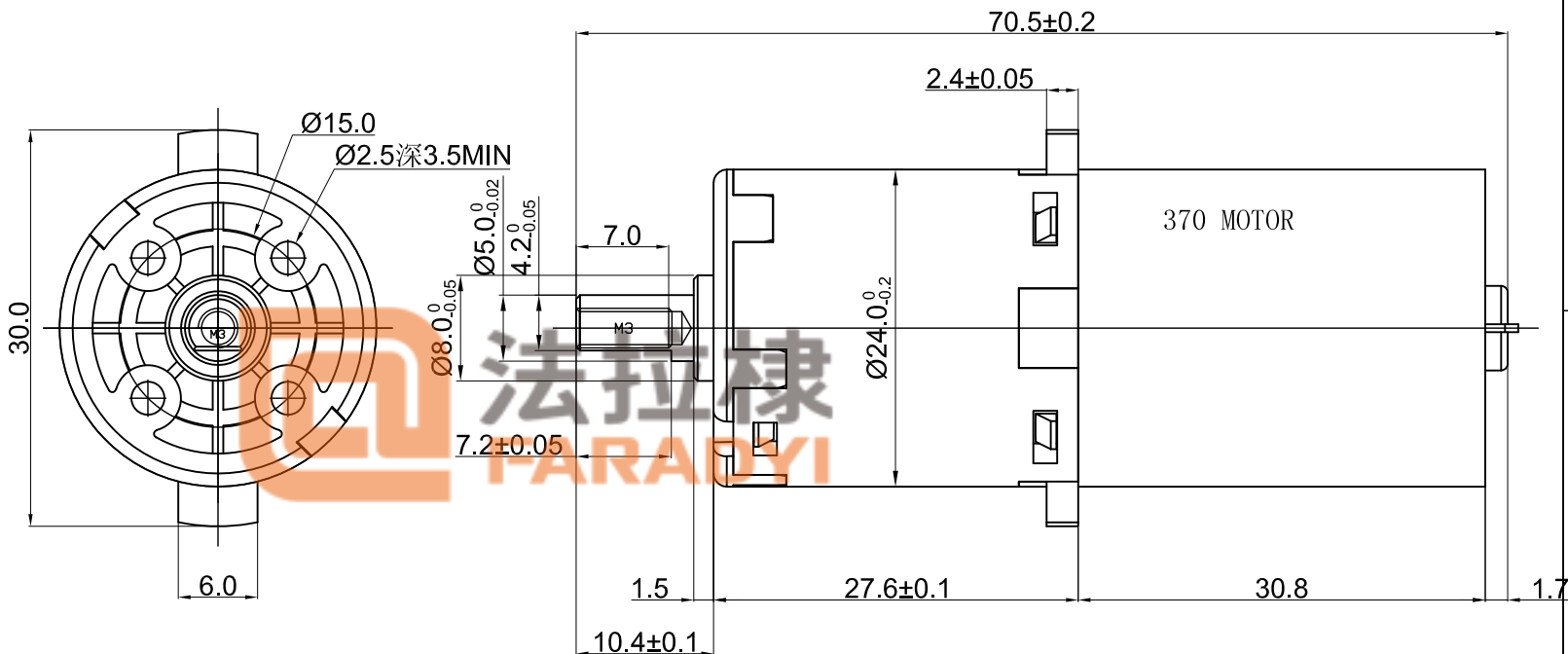

噪声测试方法: 探头距减速器10cm, 环境噪音30db测试
Noise test method: 10cm away from the reducer,
environmental noise 30db

Tolerance (GB/T1804)	
Size Range	Tolerance
Under3	±0.05
3~6	±0.05
6~20	±0.1
Above20	±0.15

制图 Formulate	黄朝文	2022-7-2	外形图 Outside Drawing		客户确认 Confirmation Approved	
审核 Audit	黄朝文	2022-7-2	PART NO.: GB24-125-MD22006-1-M			
批准 Approved			Scale	1:1		
			重量			

A4 REVISIONS				
ZONE	REV	DESCRIPTION	DATE	APPROVED

25mm行星减速箱，传动比：23.76:1

25mm planetary gearbox with transmission ratio 23.76:1

额定电压 Rated Voltage	12.0V DC
使用环境范围 Operating Condition Temperature Range	-30~+80°C
空载转速 Noload speed	210±10% rpm
空载电流 Noload Current	≤0.6 A
负载转矩 Rated Torque	550 mN.M
负载转速 Rated Speed	180±10% rpm
负载电流 Rated Current	1A
堵转电流 Stall Current	13A
堵转力矩 Stall Torque	5 N.M
旋向 Direction	CW/CCW
噪音 Noise	≤50 dB
轴向间隙 Axial gap	0.2MAX

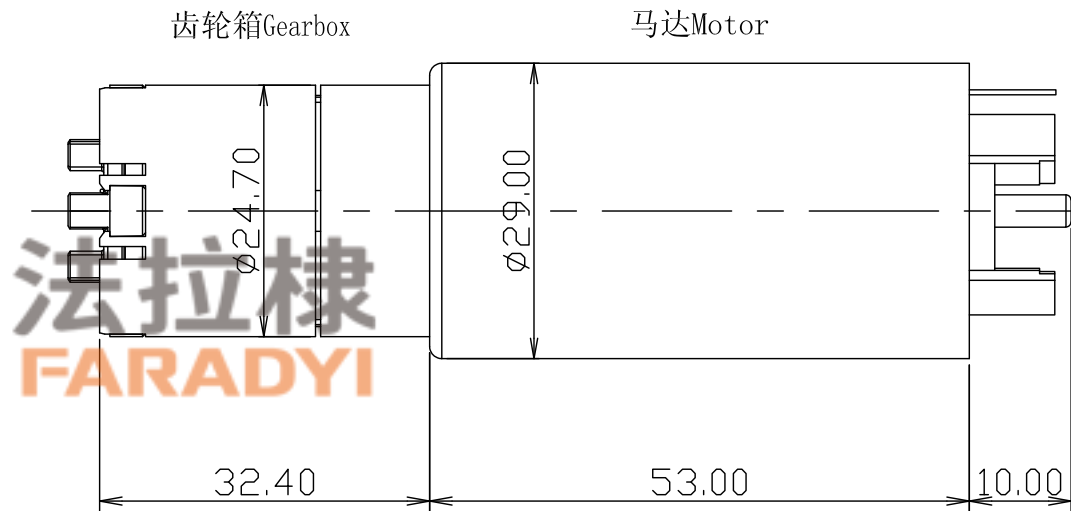
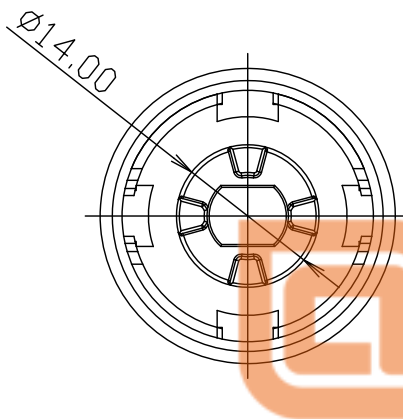

噪声测试方法：探头距减速器30cm，环境噪音31db测试
Noise test method: 30cm away from the reducer,
environmental noise 31db

Tolerance (GB/T1804)	
Size Range	Tolerance
Under3	±0.05
3~6	±0.05
6~20	±0.1
Above20	±0.15

制图 Formulate	黄朝文	2021-7-26	外形图 Outside Drawing			客户确认 Confirmation Approved		
审核 Audit			PART NO.: GB25-23-WM17002-2-M					
批准 Approved			Scale	1:1	version			A
					重量			
							共1页 第1页	

A4 REVISIONS				
ZONE	REV	DESCRIPTION	DATE	APPROVED

26mm行星减速箱，传动比：18.37

26mm planetary gearbox with transmission ratio 18.37:1

额定电压 Rated Voltage	12.0V DC
使用环境范围 Operating Condition Temperature Range	-30~+80°C
空载转速 Noload speed	530±10% rpm
空载电流 Noload Current	≤1.2 A
负载转矩 Rated Torque	400 mN.M
负载转速 Rated Speed	480±10% rpm
负载电流 Rated Current	4A

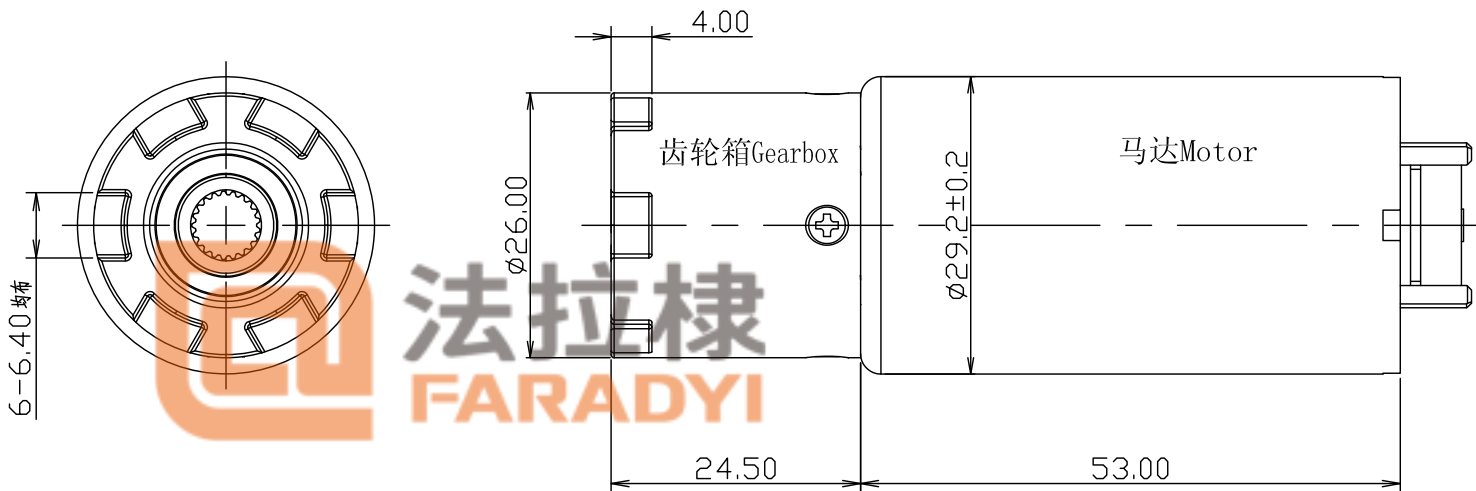

内花键齿形参数		Internal spline tooth profile parameters	
齿轮类别	IS04156	Type of gear	IS04156
齿形	渐开线齿形	Gear shape	Involute tooth profile
模数(m)	0.3	Modulus(m)	0.3
压力角(a)	30°	Pressure angle(a)	30°
齿数(Z)	21	Number of teeth(z)	21
变位系数(x)	+0	Modification coefficient(x)	+0
分度圆直径(d ₀)	Φ6.30	Diameter of index circle(d ₀)	Φ6.30
花键大径(d _a)	Φ6.75 ^{+0.1} ₀	Spline diameter(da)	Φ6.75 ^{+0.1} ₀
花键小径(d _f)	Φ6.03 ^{+0.12} ₀	Spline trail(df)	Φ6.03 ^{+0.12} ₀
测量齿数(Z _m)	4枚	Measure the number of teeth(z _m)	4 PCS
测量齿厚(S _m)	3.185 ^{+0.05} ₀	Measure tooth thickness(sm)	3.185 ^{+0.05} ₀
齿形精度等级	/	Tooth profile accuracy grade	/

噪声测试方法：探头距减速器30cm，环境噪音31db测试
Noise test method: 30cm away from the reducer, environmental noise 31db

Tolerance (GB/T1804)	
Size Range	Tolerance
Under3	±0.05
3~6	±0.05
6~20	±0.1
Above20	±0.15

堵转电流 Stall Current	27A
堵转力矩 Stall Torque	40 kg. cm
旋向 Direction	CW/CCW
噪音 Noise	≤50 dB
轴向间隙 Axial gap	0.2MAX

制图 Formulate	黄朝文	2021-7-26	外形图 Outside Drawing		客户确认 Confirmation Approved	
审核 Audit			PART NO.: GB26-18-WM17003-1-M			
批准 Approved			Scale	1:1	version	A
			重量			

A4 REVISIONS				
ZONE	REV	DESCRIPTION	DATE	APPROVED

28mm行星减速箱，传动比：22:1

28mm planetary gearbox with transmission ratio 22:1

额定电压 Rated Voltage	12.0V DC
使用环境范围 Operating Condition Temperature Range	-30~+80°C
空载转速 Noload speed	440±10% rpm
空载电流 Noload Current	≤1.2 A
负载转矩 Rated Torque	475 mN.M
负载转速 Rated Speed	404±10% rpm
负载电流 Rated Current	4A
堵转电流 Stall Current	27A
堵转力矩 Stall Torque	47 kg.cm
旋向 Direction	CW/CCW
噪音 Noise	≤50 dB
轴向间隙 Axial gap	0.2MAX

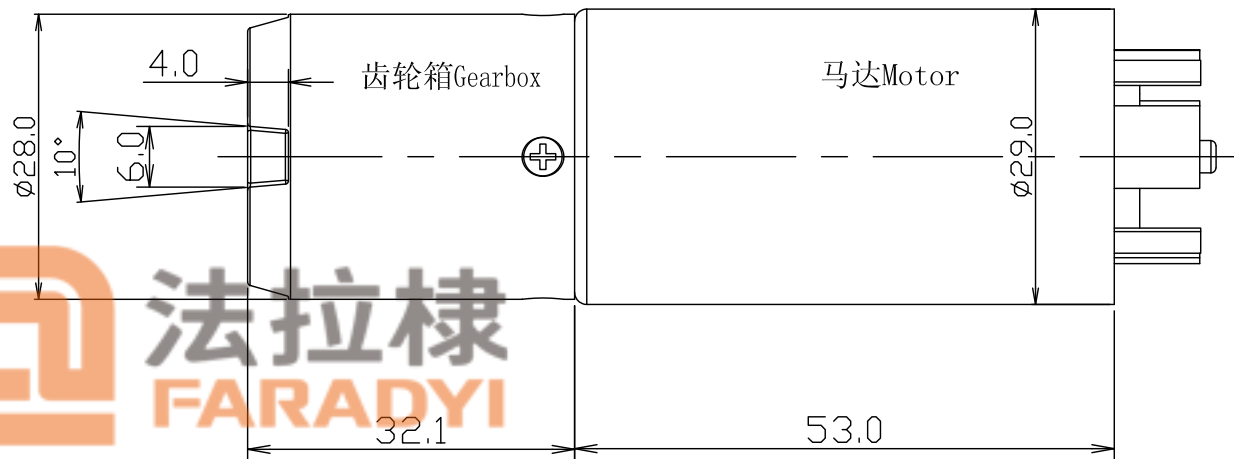
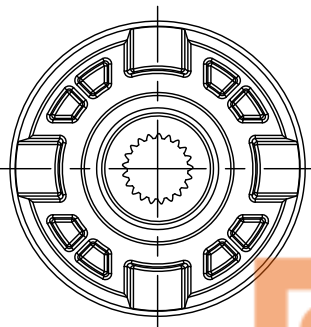

内花键齿形参数		Internal spline tooth profile parameters	
齿轮类别	ISO4156	Type of gear	ISO4156
齿形	渐开线齿形	Gear shape	Involute tooth profile
模数(m)	0.3	Modulus(m)	0.3
压力角(a)	30°	Pressure angle(a)	30°
齿数(Z)	21	Number of teeth(z)	21
变位系数(x)	+0	Modification coefficient(x)	+0
分度圆直径(d ₀)	φ6.30	Diameter of index circle(d ₀)	φ6.30
花键大径(d _a)	φ6.75 ^{+0.1} ₀	Spline diameter(d _a)	φ6.75 ^{+0.1} ₀
花键小径(d _f)	φ6.03 ^{+0.12} ₀	Spline trail(d _f)	φ6.03 ^{+0.12} ₀
测量齿数(Z _m)	4枚	Measure the number of teeth(z _m)	4 PCS
测量齿厚(S _m)	3.185 ^{+0.05} ₀	Measure tooth thickness(s _m)	3.185 ^{+0.05} ₀
齿形精度等级	/	Tooth profile accuracy grade	/

噪声测试方法：探头距减速器30cm，环境噪音31db测试
Noise test method: 30cm away from the reducer, environmental noise 31db

Tolerance (GB/T1804)	
Size Range	Tolerance
Under3	±0.05
3~6	±0.05
6~20	±0.1
Above20	±0.15

制图 Formulate	黄朝文	2021-7-26	外形图 Outside Drawing		客户确认 Confirmation Approved	
审核 Audit			PART NO.: GB28-22-WM17003-1-M			
批准 Approved			Scale	1:1	version	A
			⊕	⊖	重量	
						共1页 第1页

A4 REVISIONS				
ZONE	REV	DESCRIPTION	DATE	APPROVED

30mm行星减速箱，传动比：18.37

30mm planetary gearbox with transmission ratio 18.37:1

额定电压 Rated Voltage	12.0V DC
使用环境范围 Operating Condition Temperature Range	-30~+80°C
空载转速 Noload speed	530±10% rpm
空载电流 Noload Current	≤1.2 A
负载转矩 Rated Torque	400 mN.M
负载转速 Rated Speed	480±10% rpm
负载电流 Rated Current	4A

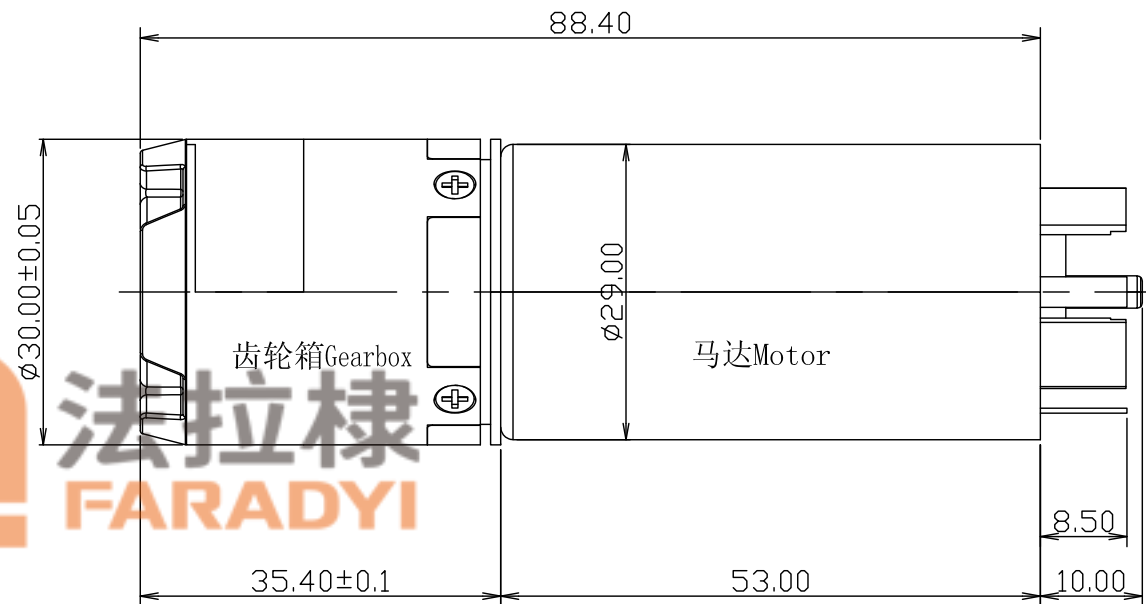
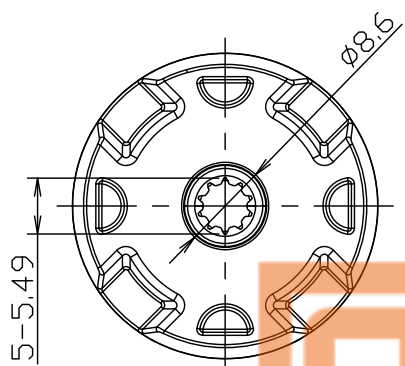

堵转电流 Stall Current	27A
堵转力矩 Stall Torque	40 kg.cm
旋向 Direction	CW/CCW
噪音 Noise	≤50 dB
轴向间隙 Axial gap	0.2MAX

内花键齿形参数		Internal spline tooth profile parameters	
齿形	IS04156	Type of gear	IS04156
模数(m)	0.5	Modulus(m)	0.5
压力角(a)	30°	Pressure angle(a)	30°
齿数(Z)	10	Number of teeth(z)	10
变位系数(x)	0	Modification coefficient(x)	0
分度圆直径(d0)	φ5.0	Diameter of index circle(d0)	φ5.0
花键小径	* φ4.60 ^{+0.1} ₀	Spline trail(df)	* φ4.60 ^{+0.1} ₀
花键大径	* φ5.75 ^{+0.1} ₀	Spline diameter(da)	* φ5.75 ^{+0.1} ₀
测量齿数(Zm)	2	Measure the number of teeth(zm)	2 pcs
测量齿厚(Sm)	* 2.305 ^{+0.052} ₀	Measure tooth thickness(sm)	* 2.305 ^{+0.052} ₀
齿形精度等级		Tooth profile accuracy grade	

噪声测试方法：探头距减速器30cm，环境噪音31db测试
Noise test method: 30cm away from the reducer, environmental noise 31db

Tolerance (GB/T1804)	
Size Range	Tolerance
Under3	±0.05
3~6	±0.05
6~20	±0.1
Above20	±0.15

制图 Formulate	黄朝文	2021-7-26	外形图 Outside Drawing			客户确认 Confirmation Approved	
审核 Audit			PART NO.: GB30-19-WM17001-M				
批准 Approved			Scale	1:1	version	A	
			重量				

双头颈部按摩减速箱 传动比 145.36: 1

A4 REVISIONS				
ZONE	REV	DESCRIPTION	DATE	APPROVED

额定电压 Rated Voltage	3.7V DC
使用环境范围 Operating Condition Tempertature Range	-20~+50°C
空载转速 Noload speed	34 ±10% rpm
空载电流 Noload Current	≤160 mA
负载转矩 Rated Torque	3 Kg. cm
负载转速 Rated Speed	20±10% rpm
负载电流 Rated Current	180 mA
堵转电流 Stall Current	3.2 A
堵转力矩 Stall Torque	13 Kg. cm
旋向 Direction	CW/CCW
噪音 Noise	≤55 dB
轴向间隙 Axial gap	0.4MAX

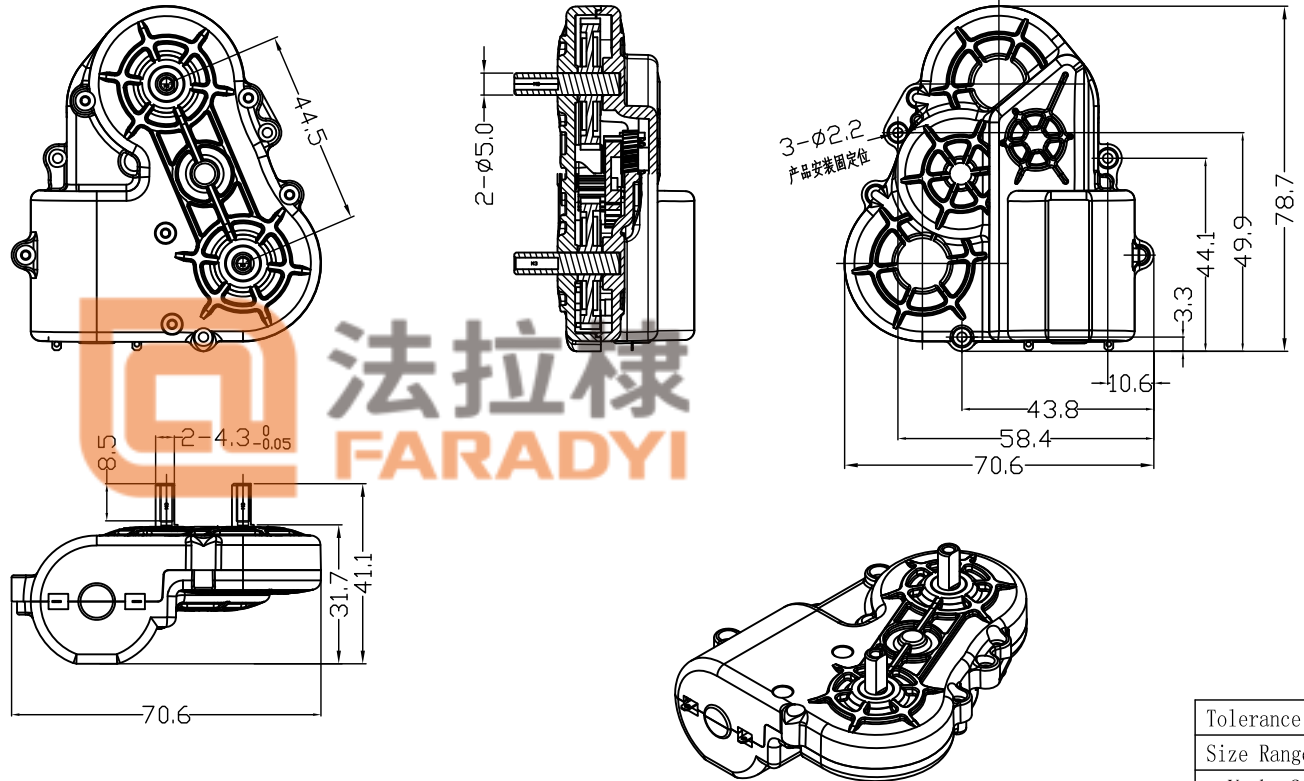

噪声测试方法: 探头距减速器20cm, 环境噪音31db测试
Noise test method: 20cm away from the reducer,
environmental noise 31db

Tolerance (GB/T1804)	
Size Range	Tolerance
Under3	±0.05
3~6	±0.05
6~20	±0.1
Above20	±0.15

制图 Formulate	黄朝文	2022-7-12	外形图 Outside Drawing		客户确认 Confirmation Approved	
审核 Audit			PART NO.: DGAMQ-DZ22004-2-M			
批准 Approved			Scale	1:1	version	A
			⊕	≡	重量	
						共1页 第1页